



EX-3U 3.5" Serviceable Kiosk Media Card Reader

Overview:

Photo Kiosks are getting more and more popular due to the high growth of digital photography. As a result of this, kiosks in high commercial or industrial usages require their components to be serviced more frequently due to the increase in wear and tear. Ease of serviceability is the key to decreasing down time for the kiosk owner.

Atech Flash Technology (AFT), one of the fastest growing digital card reader manufacturers has addressed this issue and is offering a Serviceable digital media reader. The EX-3U has all the functions of a multi-card reader, but its main strength is its serviceability. It comes with a key specially designed to eject and remove the serviceable part of the reader. Replacing or updating the EX-3U reader unit only takes a few minutes versus an hour or more using conventional card readers.

To keep things simple, the EX-3U is based on the traditional 3.5" drive bay size so you can add this to your existing USB enabled PC system or Kiosk System. Utilizing the Hi-Speed USB 2.0 interface, it is the best solution for performance, reliability and value. This will also ensure that compatibility or upgradeability for existing kiosks or PC systems.

Features:

EX-3U has many great features that utilize today's latest technologies.

- Retractable front cartridge for easy service
- 5 card slots to support all popular media cards
- Front USB port for USB devices (i.e. USB Drives)
- Fits into standard 3.5" drive bay
- Pin-Protected CompactFlash socket design
- MS-Duo, MS-Micro, microSD, miniSD insertion without adapters
- Color Silkscreen for easy ID of media card slots
- Supports the latest high capacity cards like SDXC and UDMA.



Service Key to eject Reader Cartridge



Hardware Specifications:

- Dimension (W x H x D): 102 mm x 25 mm x 123 mm
- Power Requirements: USB bus-powered
- USB 2.0 Connector for connectivity

Software Specifications:

- Read-only driver available to prevent potential corruption or damage of media cards.
- On-board chip for future upgrades and enhancements
- Custom icons for drive letters

Media Cards Supported:

CompactFlash™ Type I and II
 CompactFlash UDMA
 Microdrive™
 Secure Digital™ (SDHC / SDXC)
 miniSD™ (SDHC)
 microSD™ (SDHC / SDXC)
 MultiMediaCard™
 RS-MMC V4.0
 Memory Stick PRO
 Memory Stick Duo
 Memory Stick Micro (M2)
 xD-Picture Card™ Type h
 xD-Picture Card™ Type m

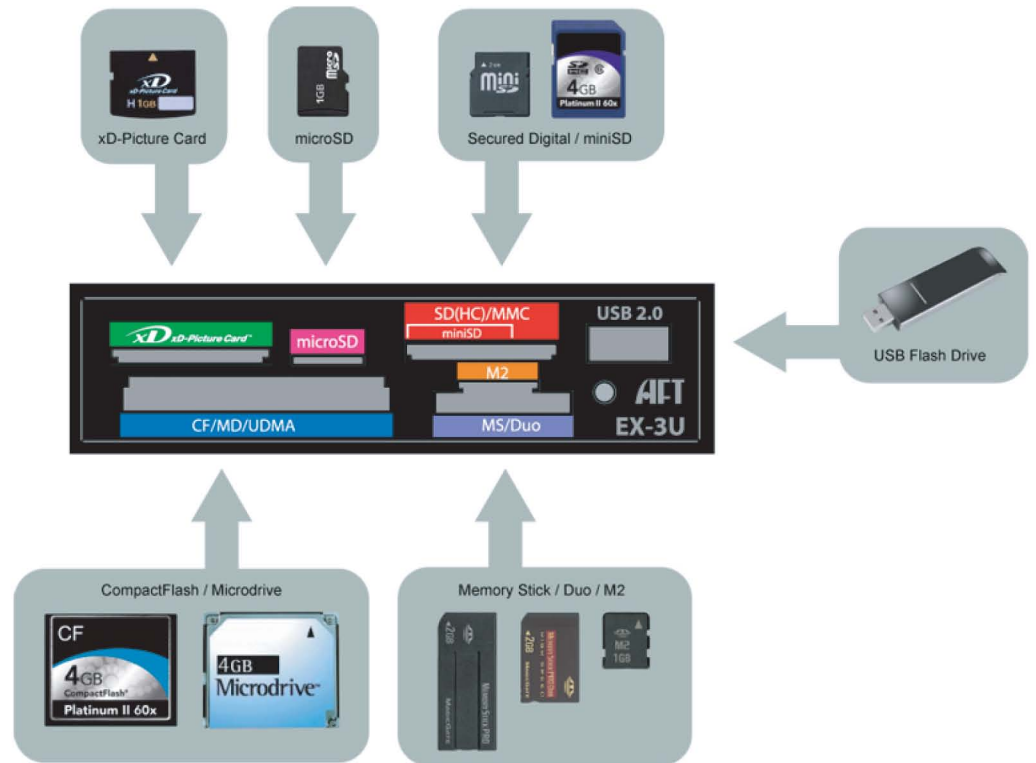

Certifications & Licenses:



Other certifications or licenses not shown can be done by customer requests
 Specifications are subject to change without further notice.

All trademarks, trade names and copyrights are properties of their respective owners.

Patented Product

US Patent #s: 6,705,878 ; 7,066,392 others pending.